



**Scaleton™
Sets The Standard
In Corrosion
Resistance**

Model VMF-90A™ Volumetric Screw Feeder

- Automatic metering screw feeder for dispensing powdered or pelletized material into a secondary process
- Ideal for water, wastewater and chemical processing applications
- Heavy-duty, gear driven auger for metering mechanism
- Built-in hopper capacity of 1.5 cu. ft.
- Feed rate 0.07 to 10.19 cu. ft. per hour
- Accuracy of within 1% of volume
- Optional "Loss in Weight" measurement system



Standard Features

- Rugged, corrosion resistant stainless steel frame
- Built-in stainless steel gravity fed hopper with integrated load cell attachment point
- Concentric helical overwind auger
- Stainless steel 0.50", 0.75" or 1.5" diameter solid auger with "bayonet" style connection
- Mechanical, cam actuated hopper agitator/material conditioner
- Water and dust proof NEMA 4X, variable speed motor controller capable of remote installation
- 90 VDC right-angle geared, wash down motor

Options

- Integrated "Loss of Weight" measurement system with 4 load cells and scale controller
- 316 Stainless steel construction
- Hopper extensions and lift-off covers
- Single and bulk bag loaders
- SCADA programmable and HMI PLC touch screen motor controllers
- Washguard® and explosion proof motors
- Mixing tanks, wetting cones and eductors
- Electric or pneumatic vibratory agitators
- Dust collectors, feeder stands and leveling feet

Scaleton Industries Ltd.

Bedminster Industrial Park
53 Apple Tree Lane • P.O. Box 365
Plumsteadville, PA 18949 • USA

Tel: (+1) 215-766-2670 (International)
Tel: (+1) 800-257-5911 (USA & Canada)
Fax: (+1) 215-766-2672

Email: info@scaletonscales.com
Website: www.scaletonscales.com

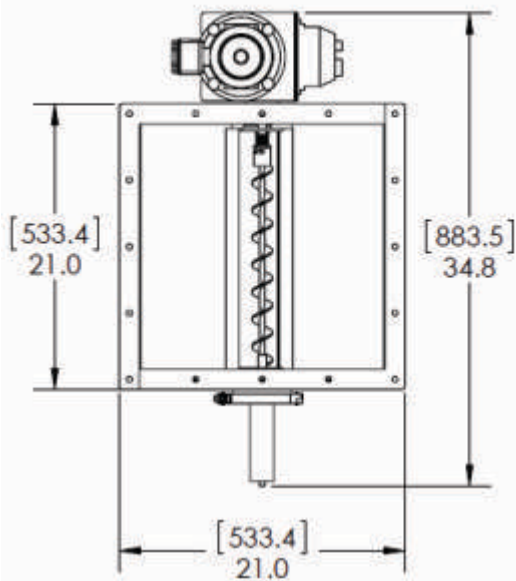

Model VMF-90A™ Volumetric Screw Feeder General Specifications

CE 2 year *FULL* warranty
on *ALL* feeders!

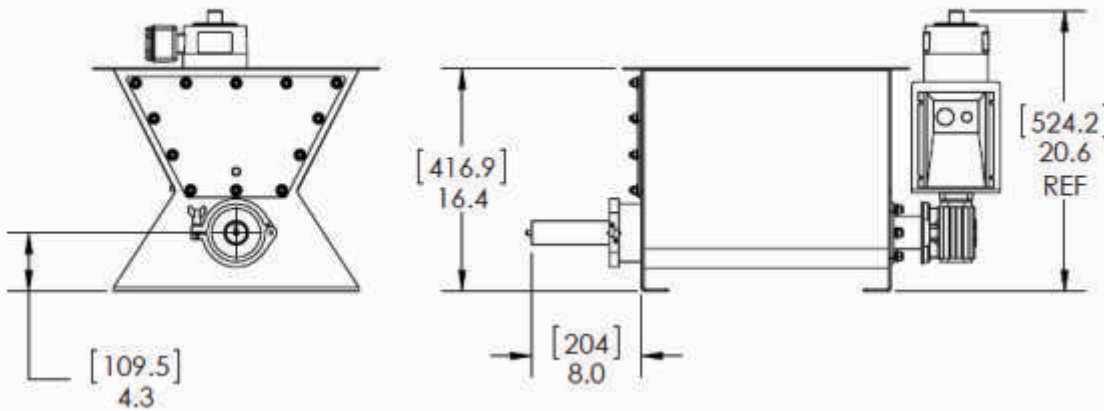

NOTES: UNLESS
OTHERWISE SPECIFIED
1. DIMENSION WILL
CHANGE DEPENDING
UPON APPLICATION

Hopper Capacity:	1.5 cu. ft. — custom sizes available
Feed Rate:	0.07 to 10.19 cu. ft. per hour
Accuracy:	1% of volume
Feed Screw:	0.50", 0.75" or 1.5" diameter solid auger in 304 or 316 stainless steel – custom sizes available
Overwind Helix:	304 or 316 stainless steel
Controls:	Variable speed DC NEMA 4X, SCR motor control (SCADA programmable and HMI PLC touch screen controllers available)
Control Input:	4-20 mA
Motor Type:	Right-angle geared, TENV 90 VDC, wash down motor 1/2 HP, 83 RPM
Available Motors:	Washguard® - 1/2 HP motor and gearing - Explosion proof - 1/2 HP motor and gearing
Vibratory Agitator (Optional):	Electric or pneumatic styles
Ambient Temperature Limit:	10° C - 40° C
Power:	115 VAC, 50-60 Hz, 4 Amps
Shipping Weight:	Contact Factory

Typical Specifications

The Volumetric Screw Feeder must have rugged stainless steel frame. The feeder shall include a heavy-duty, gear driven auger metering mechanism with a stainless steel auger, concentric helical overwind auger and built-in stainless steel gravity fed hopper. All hardware shall be stainless steel. A water and dust proof variable speed control must be capable of remote installation and housed in NEMA 4X, UL approved enclosure. Auger shall be powered by a 1/2 HP DC motor and have integrated mechanical cam actuated hopper agitator/material conditioner.

Scale shall be a Model VMF-90A™ as manufactured by Scaletron Industries Ltd., Plumsteadville, PA.

OPTIONS FOR "LOSS OF WEIGHT SYSTEM":

The optional "Loss of Weight" measurement system shall include four (4) NTEP approved stainless steel shear beam cells and stainless steel leveling bolts. A variety of scale indicators and controllers are available.